

# CORPORATE SUITES & SYNDICATE ROOMS



## SHANNON, GARRYOWEN AND CRESCENT SUITES

Offering natural lighting, these self-contained boardrooms are popular for tutorials and smaller private meetings. The suites are interconnecting and can be combined to create a larger space – ideal for larger meetings or as breakout rooms.

### Garryowen / Crescent Suite Capacities

Board Style: 20  
Theatre Style: 50  
Classroom Style: 20  
U-Shaped Style: 15

### Shannon Suite Capacities

Board Style: 8  
Theatre Style: 20  
Classroom Style: 16  
U-Style: -

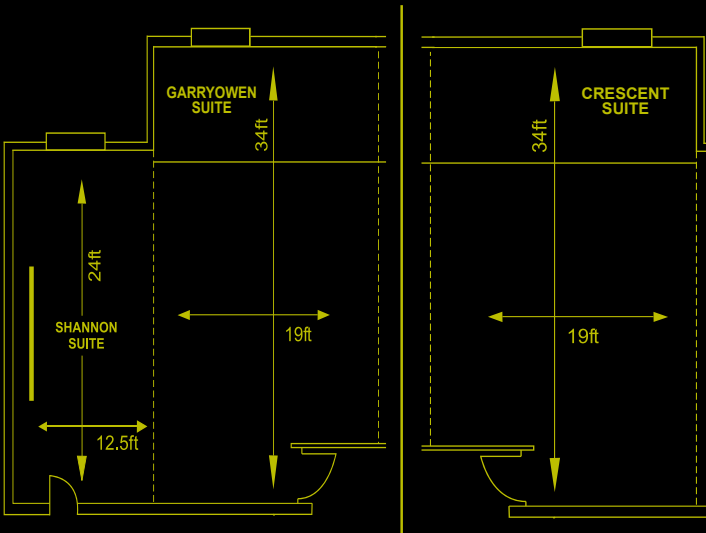

## THE THOMOND SUITE

The popular and multifunctional Thomond Suite is suitable for meetings, functions and other private events. The room has a capacity for up to 200 persons and features traditional detailing, natural lighting and full bar facilities.

### Thomond Suite Capacities

Banquet Style: 200  
Theatre Style: 150  
Classroom Style: 85

### Floor Area of Rooms

Room	m <sup>2</sup>	ft. <sup>2</sup>
Reception	71.75	772
Function	151.00	1625

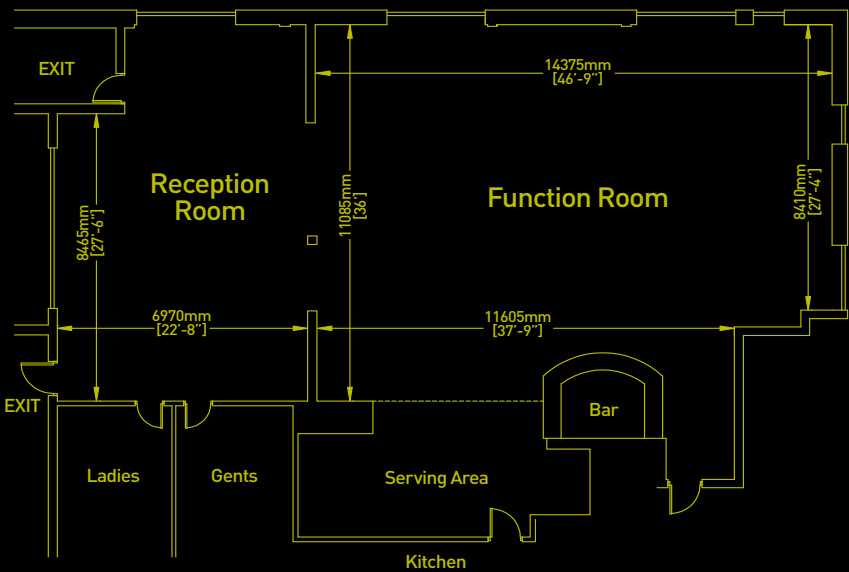

## SYNDICATE ROOMS

The South Court Hotel also features four smaller meeting rooms. With varying capacities, the Syndicate Rooms are ideal for boardroom meetings, interviews or small breakout sessions.

TO ARRANGE AN INSPECTION OR FOR A DETAILED PROPOSAL,  
CONTACT OUR MEETINGS & EVENTS DEPARTMENT

Great National South Court Hotel, Raheen Roundabout, Raheen, Limerick, Ireland  
t. +353 (0) 61 487 487 | e. [events@southcourthotel.com](mailto:events@southcourthotel.com) | w. [southcourthotel.com](http://southcourthotel.com)

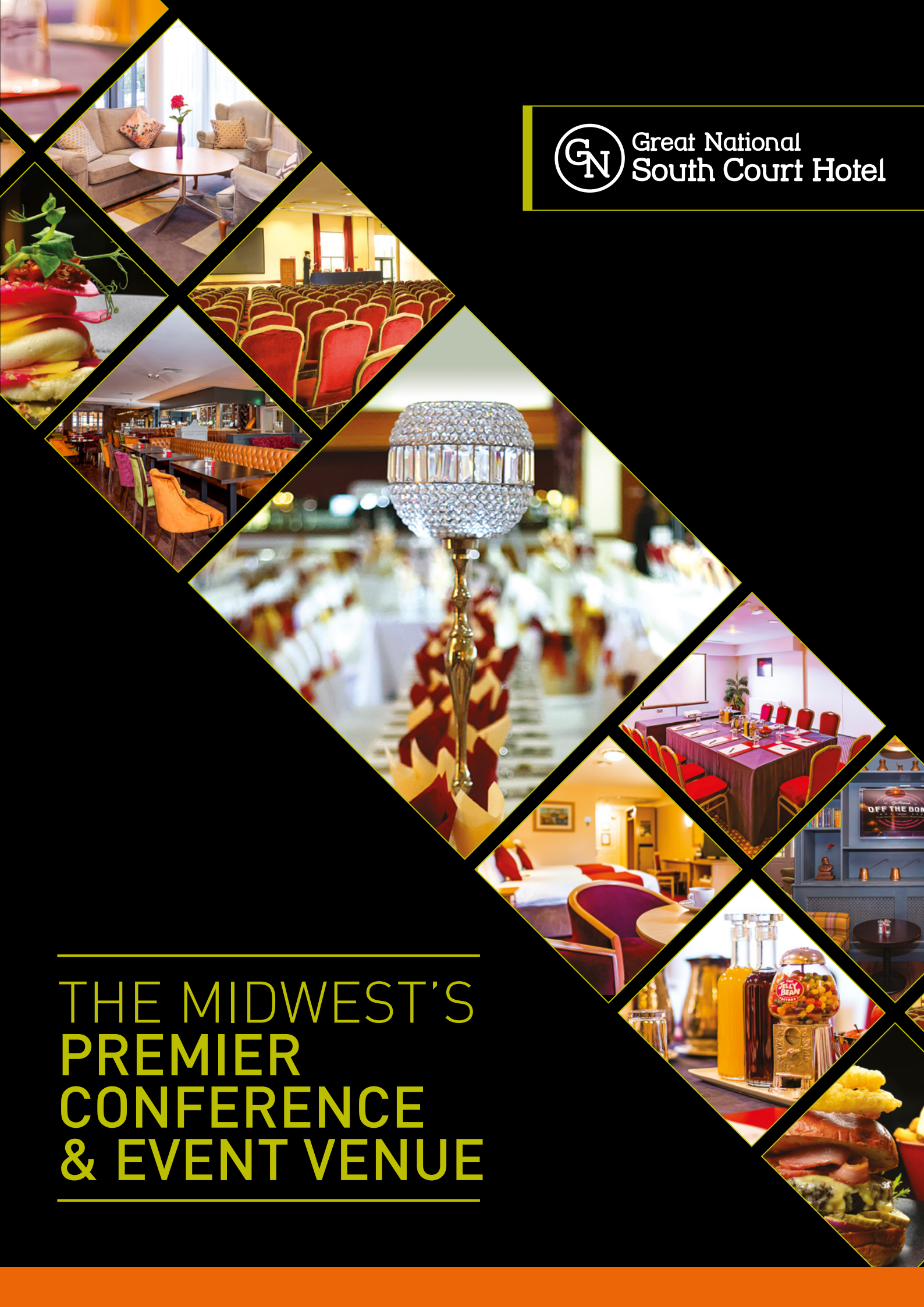

THE MIDWEST'S  
PREMIER  
CONFERENCE  
& EVENT VENUE